

1 of 8

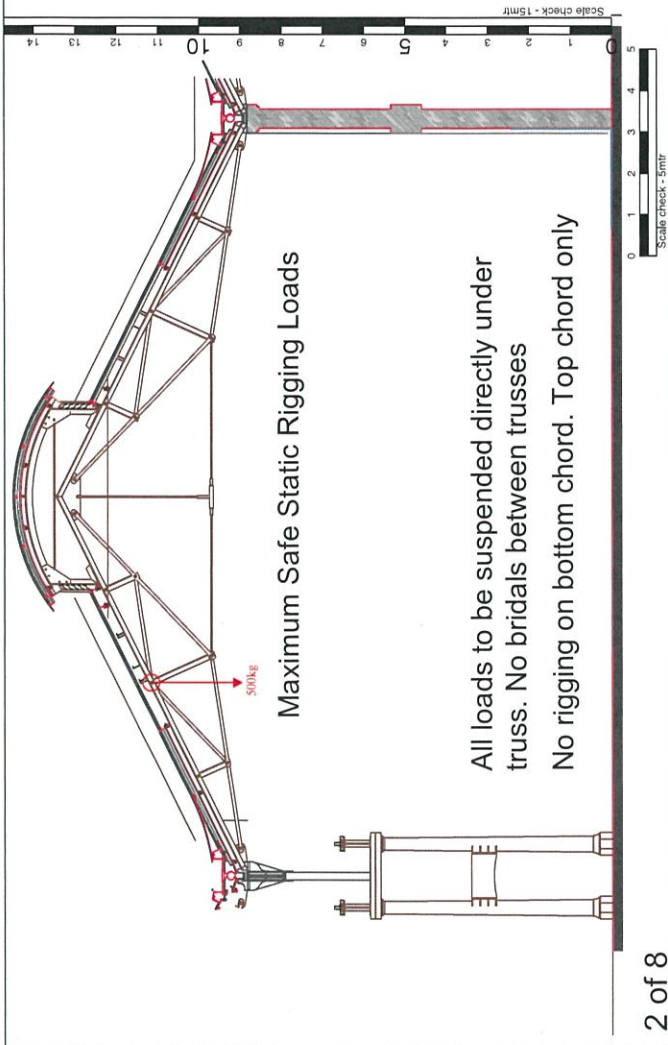

2 of 8

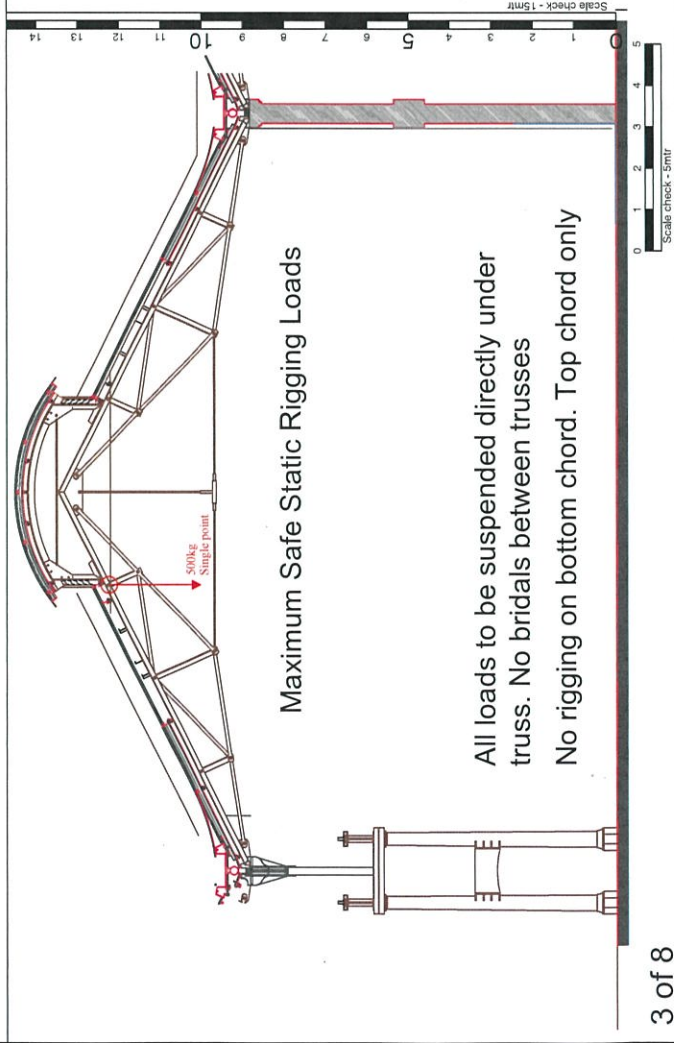

3 of 8

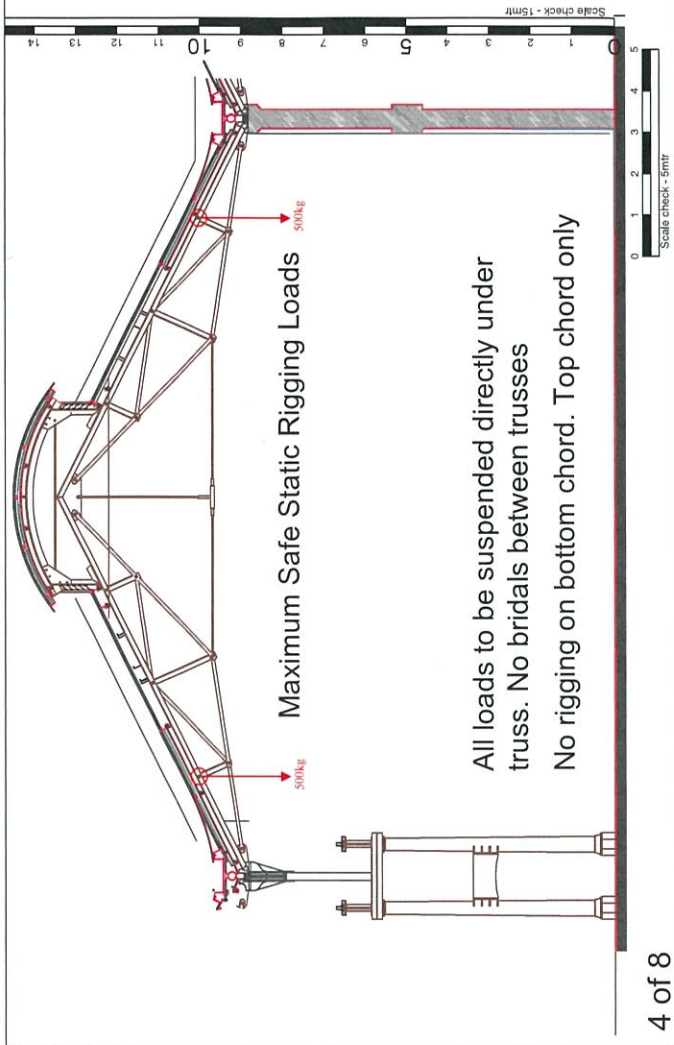

4 of 8

These diagrams indicate safe static working loads that may be applied to various points on the top chord of the existing roof trusses. Safe loadings are only shown for one truss, and equivalent loadings may be applied to an adjacent truss if required. It **must** be noted that the existing trusses are cast/wrought iron, and this material is quite brittle and does not withstand shock well. The loads given are static loads, and an appropriate safety factors need to be applied if dynamic loads are proposed. Please note that these diagrams are an indication only and that individual trusses may need to be assessed prior and during installation for suitability.

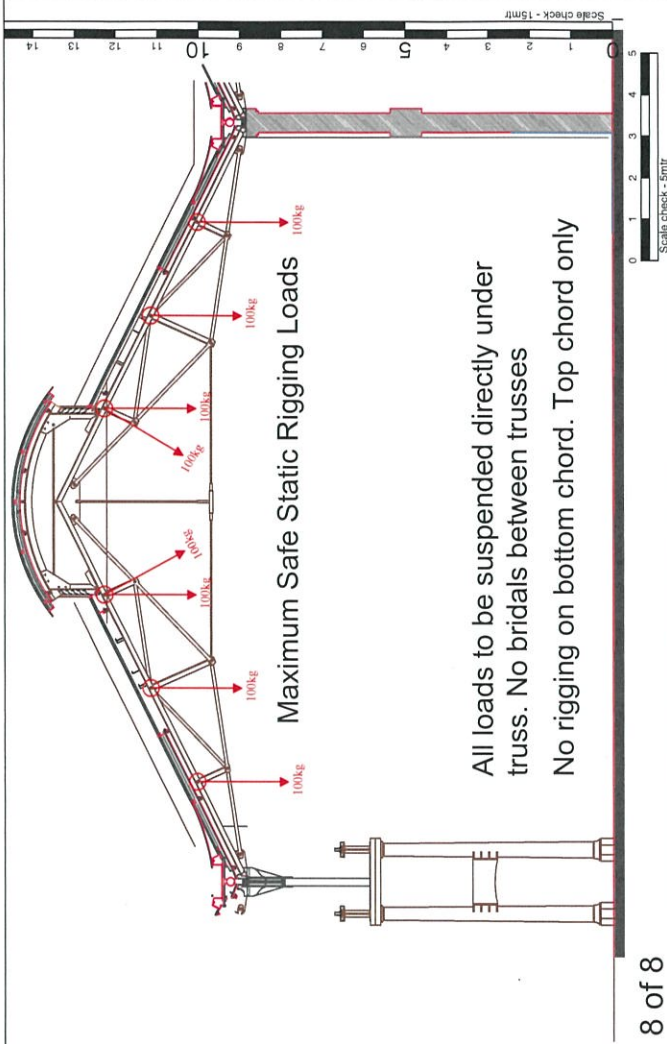
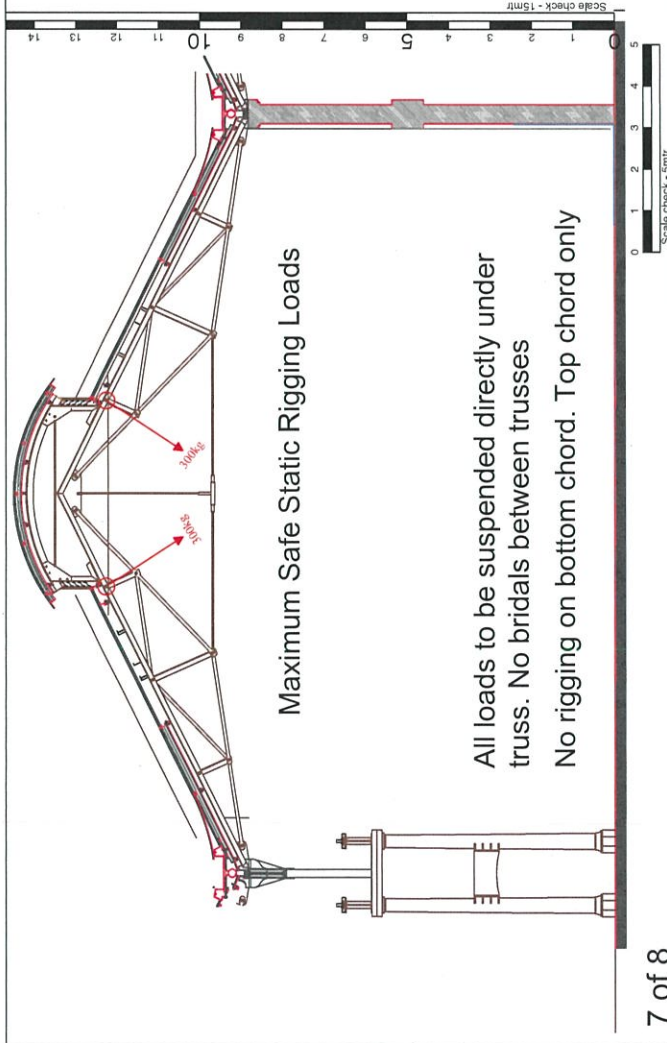
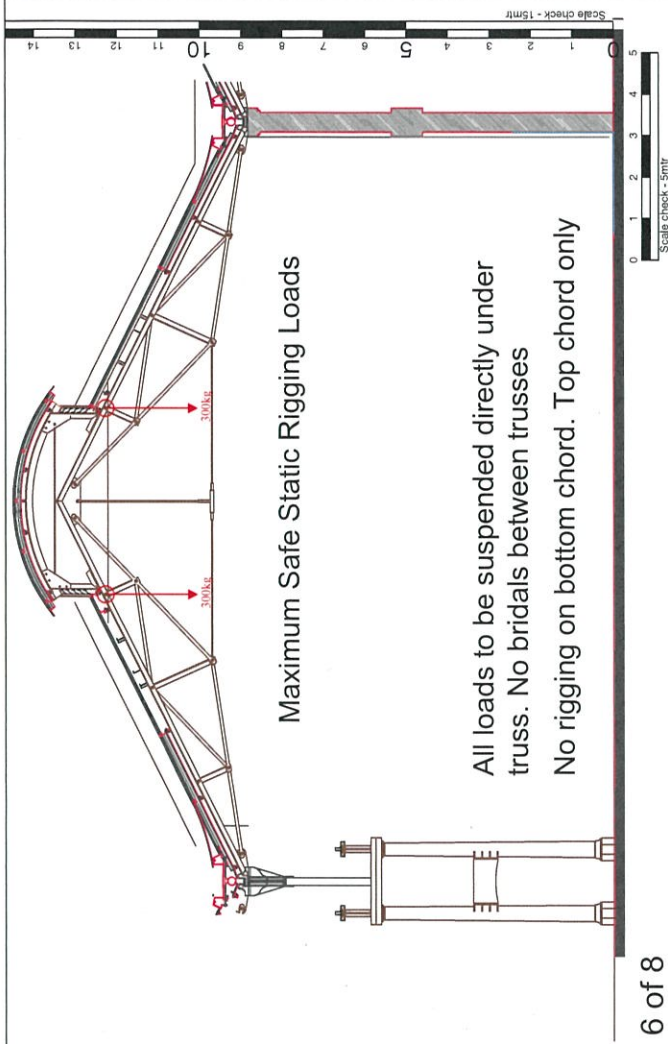
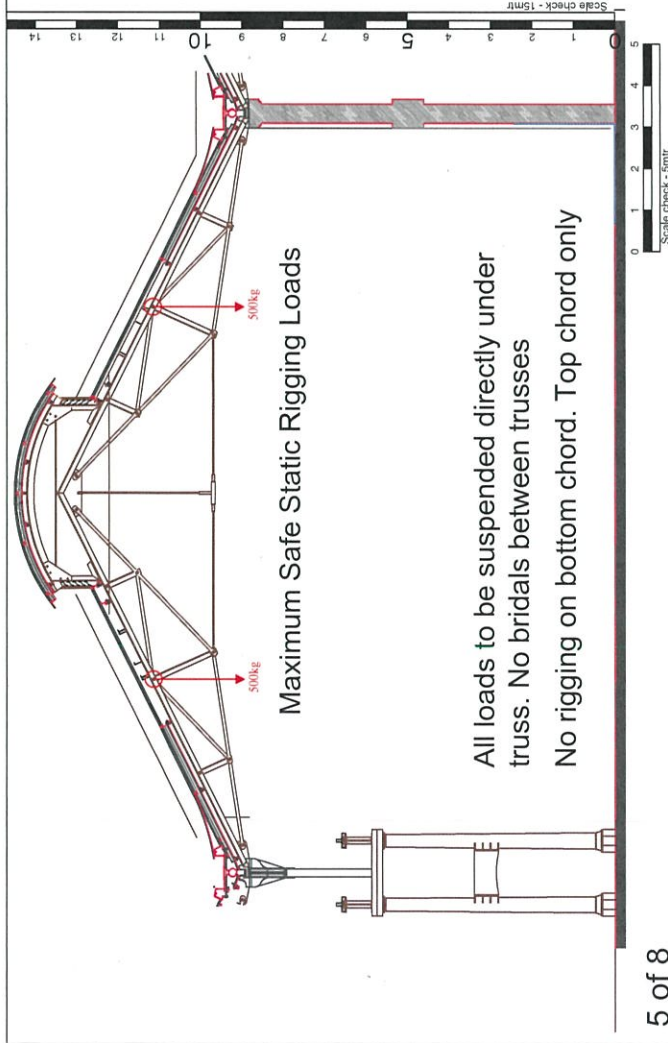

These diagrams indicate safe static working loads that may be applied to various points on the top chord of the existing roof trusses. Safe loadings are only shown for one truss, and equivalent loadings may be applied to an adjacent truss if required. It **must** be noted that the existing trusses are cast / wrought iron, and this material is quite brittle and does not withstand shock well. The loads given are static loads, and an appropriate safety factors need to be applied if dynamic loads are proposed. Please note that these diagrams are an indication only and that individual trusses may need to be assessed prior and during installation for suitability.

|             |            |           |    |       |    |        |                                     |
|-------------|------------|-----------|----|-------|----|--------|-------------------------------------|
| Project No. | 1000000000 | Sheet No. | V1 | Scale | A4 | Client | Carriageworks                       |
|             |            |           |    |       |    |        | Heritage Roof Trusses Loads Sheet 2 |
|             |            |           |    |       |    |        | Carriageworks                       |

All Rigging Plans must comply with the appropriate Code of Practice for the installation of RIGGING EQUIPMENT ONLY. Please check all critical dimensions prior.